

Experience  
Innovation  
Quality  
Profitability

# OLETTO

## Thermo Asphalt Container/Hot-Box



The OLETTO Hot-Box/Thermo Asphalt Container keeps the asphalt hot all day and is the ideal pothole patcher for repairing asphalt surfaces after laying pipelines or any other depositing of small amounts of bitumen (asphalt), etc.

Insulation keeps the temperature high

Loading doors for filling

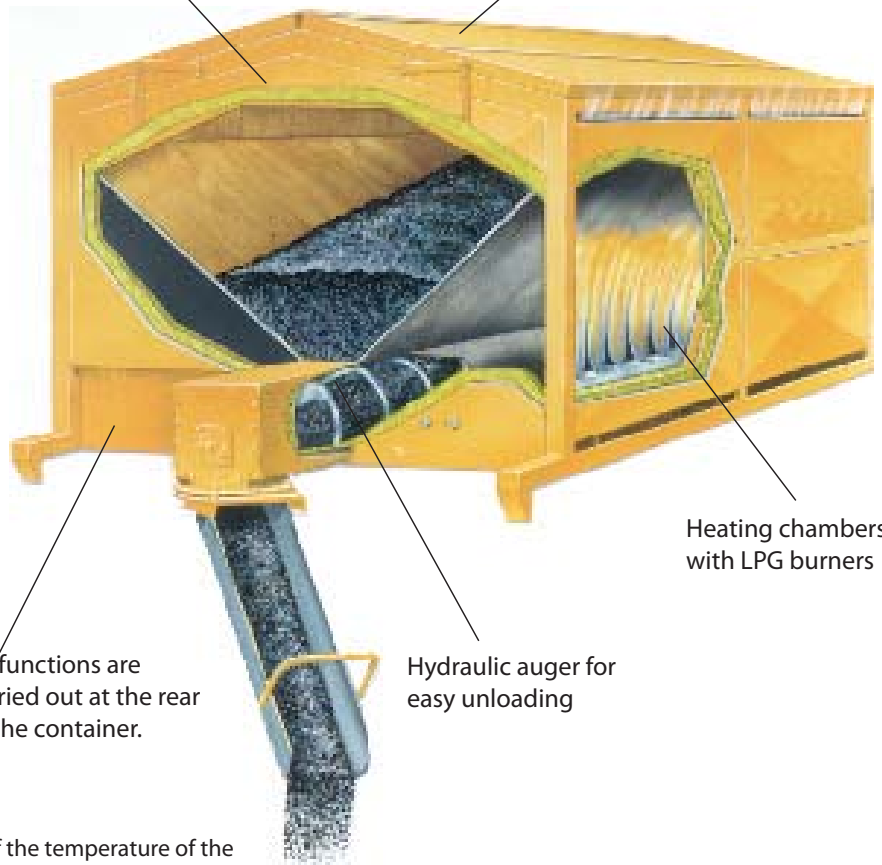

All functions are carried out at the rear of the container.

Hydraulic auger for easy unloading

Heating chambers with LPG burners

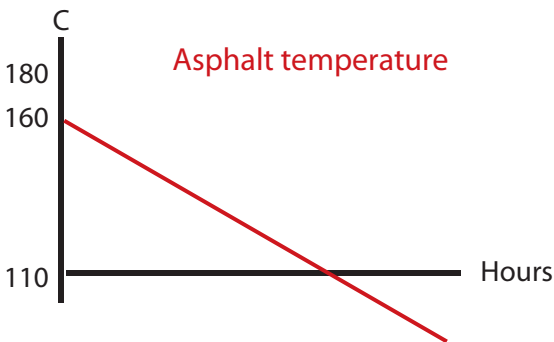

If the temperature of the bitumen goes below 115°C the quality of the repair is unacceptable and will not last long time. And result will be as on the photo up left.



Efficiency in Road Maintenance

## SOME ADVANTAGES OF THE OLETTO HOT-BOX\*



Computerized control of heating

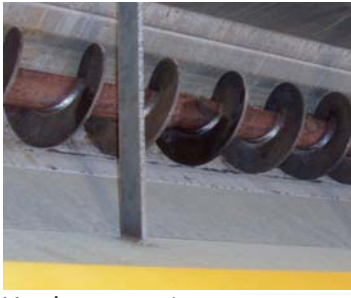

Hardox auger is standard



New system brings significant savings of gas



Turnable chute is standard



Extended chute for high lorry as option.



Platform in front side is standard



Doors opens flat with a funnel effect and with tight flaps to avoid waste when filling



Fastening eyes and securing device



Gas bottles can be placed from side or rear

## DRIVE AND HYDRAULIC OPTIONS:



Hydraulic from lorry



9 HP Honda engine for direct drive of auger (for AF 25 only)



13 HP Honda engine for petrol and gas



20HP Hatz diesel engine. Standard or super Silent

## HOW TO TRANSPORT AND STORE THE BOX:



Permanent on a lorry



Permanent on trailer



Mechanical legs for lorry with tipper



Hydraulic legs. For any kind of lorry - also for full box



Multi lift system

\* Some features are not valid for AF20 and AF25

## ACCESSORIES and OPTIONS



Dicky box



Deposit box (mini paver)



Disc spreader



Bituslip sprayer as option



Electrical control of valves and remote control as option

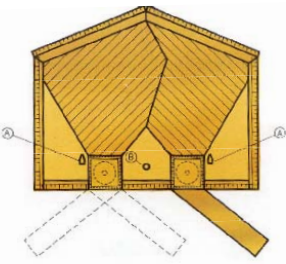

Lift to transport vibrator.



External conveyer auger in transport position

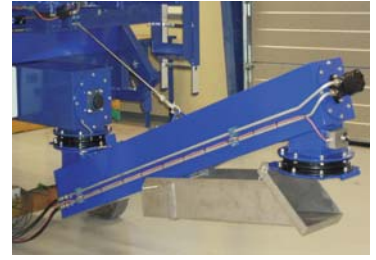

2,2, 1,7 and 1,25 m external conveyer auger



Twin chamber



Heating in auger outlet



External conveyer auger has chute, insulation and remote control of discharge auger



Platform with ladder



External hydraulic take off



Hydraulic opening of loading doors.



Auger inspection door with safety switch

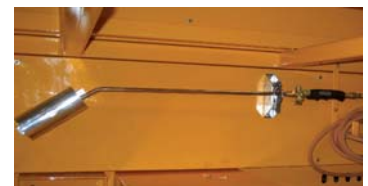

External gas burner



Built-in bonding agent (tack tar) tank



Electrical heating of auger



Fire extinguisher in locker



Search light



Rotating beacon



Crane for gas bottles

Model	AF 20	AF 25	AF 50	AF50 2K	AF 75	AF 75 2K	AF 100	AF100 2K	AF 100 H	AF100 2KH
Chambers	1	1	1	2	1	2	1	2	1	2
Thermometer *)	Analogue	Analogue	Digital	Digital	Digital	Digital	Digital	Digital	Digital	Digital
Temperature regulation*)	Manual	Manual	Automatic							
Burner type	Flame	Flame	Lamella	Lamella	Lamella	Lamella	Lamella	Lamella	Lamella	Lamella
Max. volume m <sup>3</sup>	1	1,4	2,8	3,4	4,2	5,1	5,5	6,9	7,5	8,8
Max capacity t	2,2	3,1	6,2	7,5	9,3	11,4	12,2	15,5	16,7	19,6
Lorry pay load t	3,1	4	7,7	9,2	11,1	13,4	14,3	17,9	18,9	22,0
Net weight kg	870	950	1500	1700	1800	2000	2100	2350	2200	2500
Gas consumption kg/h	1	1	2	2	3	3	4	4	5	5
Standard colour	RAL 1007 (other RAL-colours can be specified)									
Insulation	Sides and top: 50 mm. Bottom: 30 mm									
Gas pressure	0,75 bar									
*) AF-20 and AF-25 can be equipped with automatic thermostatic temperature control and lamella burners.										

Model	AF 20	AF 25	AF 50	AF50 2K	AF 75	AF 75 2K	AF 100	AF100 2K	AF 100 H	AF100 2KH
A **)	2880	2880	3820	3820	4820	4820	5820	5820	5820	5820
B **)	470	470	680	680	680	680	680	680	680	680
C	1610	1610	2290	2290	3290	3290	4290	4290	4290	4290
D	640	640	850	850	850	850	850	850	850	850
E **)	410	410	455	455	455	455	455	455	455	455
F	1770	1770	2450	2450	3450	3450	4450	4450	4450	4450
G	0	0	250	250	250	250	250	250	250	250
H	1245	1445	1620	1700	1620	1700	1620	1700	1950	1950
I	1500	1500	2000	2000	2000	2000	2000	2000	2000	2000
J	1740	1940	1930	2010	1930	2010	1930	2010	2260	2260

\*\*) The length will be increased if supplied with additional accessories such as tank for emulsion or crane.

All dimensions are in mm. Dimensions and specifications are guiding and are subject to modification without notice.

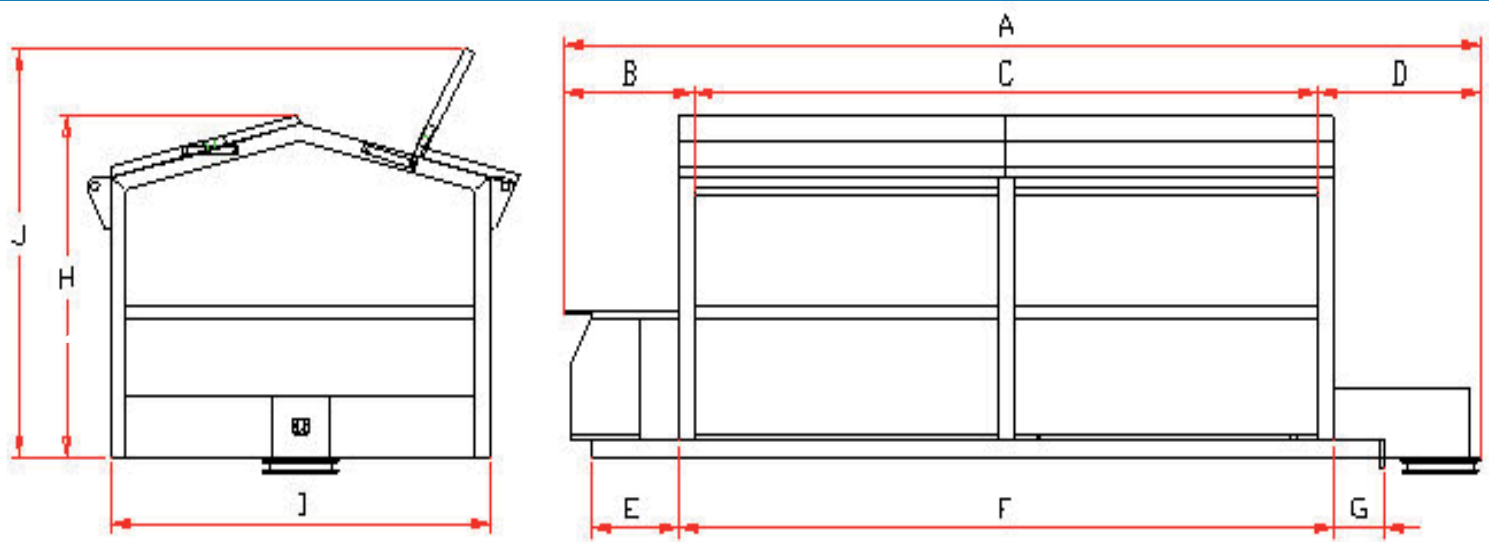

## Manufacture:

Dan-Varme

Falkevej 14  
 Balling, DK-7860 Spøttrup, Denmark  
 Phone: +45 97 56 41 08  
 Fax: +45 97 56 47 34  
 E-mail: bs@danvarme.dk

## Sale and export:

OLETTO SALES

Haandvaerkervej 159  
 DK-8600 Silkeborg, Denmark  
 Phone: +45 70 23 24 98  
 Fax: +45 70 20 62 37  
 E-mail: oletto@rostech.dk  
 www.oletto.dk

## Distribution:

Eastern Farm Machinery Ltd.  
 RR3, P.O. Box 3613  
 Guelph, On. Canada N1H 6P1  
 Tel. 5197632400, Fax 5197633930  
 www.easternfarmmachinery.com